

General Notes

STONE DUST MATERIAL SPECIFICATION
SIEVE SIZE PERCENT PASSING

3/8"	100%
#4	90 - 100%
#8	55 - 80%
#16	40 - 70%
#30	25 - 50%
#200	6 - 15%

PROCESSED AGGREGATE BASE MATERIAL SPECIFICATION SHALL BE AS DEFINED BY SECTION M.05.01-3 FORM 816

ALL WORK AND MATERIALS OF THIS CONTRACT SHALL BE IN CONFORMANCE WITH METHODS AND MATERIALS SPECIFIED IN FORM 816 UNLESS OTHERWISE SPECIFIED.

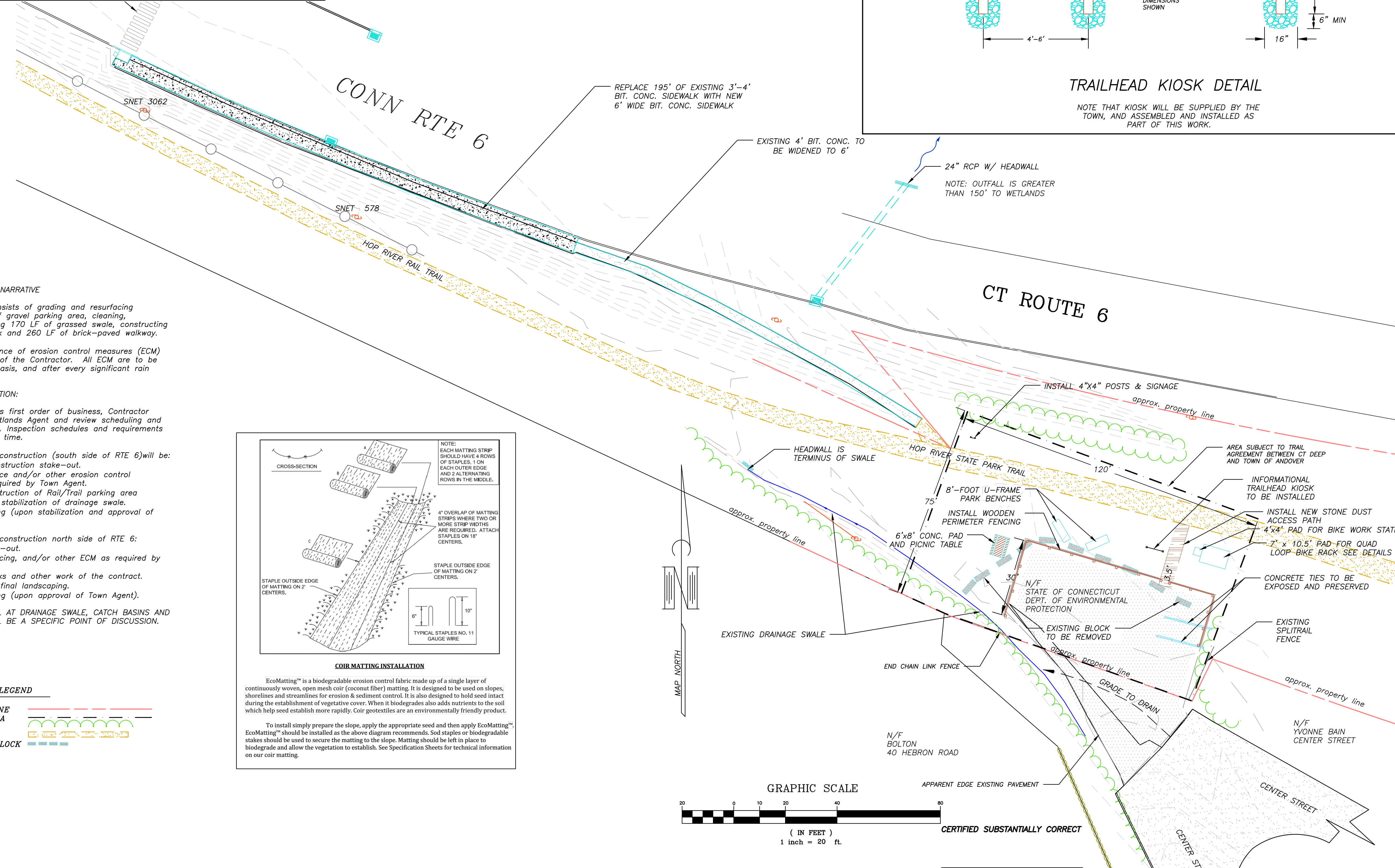

EROSION CONTROL PLAN NARRATIVE

The proposed project consists of grading and resurfacing approximately 4100 sf of gravel parking area, cleaning, re-grading, and stabilizing 170 LF of grassed swale, constructing 390 LF of p.c.c. sidewalk and 260 LF of brick-paved walkway.

Installation and maintenance of erosion control measures (ECM) will be the responsibility of the Contractor. All ECM are to be monitored on a weekly basis, and after every significant rain event.

SEQUENCE OF CONSTRUCTION:

Prior to start of work, as first order of business, Contractor shall meet with Town Wetlands Agent and review scheduling and sequence of construction. Inspection schedules and requirements will be discussed at that time.

- Anticipated sequence of construction (south side of RTE 6) will be:
- 1) Field location and construction stake-out.
 - 2) Installation of silt fence and/or other erosion control measures as may be required by Town Agent.
 - 3) Clearing/grading/construction of Rail/Trail parking area
 - 4) Cleaning grading and stabilization of drainage swale.
 - 5) Removal of silt fencing (upon stabilization and approval of Town Agent).

- Anticipated sequence of construction north side of RTE 6:
- 1) Field location & stake-out.
 - 2) Installation of silt fencing, and/or other ECM as required by Town Agent.
 - 3) Installation of sidewalks and other work of the contract.
 - 4) Site stabilization and final landscaping.
 - 5) Removal of silt fencing (upon approval of Town Agent).

NOTE: SEDIMENT CONTROL AT DRAINAGE SWALE, CATCH BASINS AND HOP RIVER BRIDGE SHALL BE A SPECIFIC POINT OF DISCUSSION.

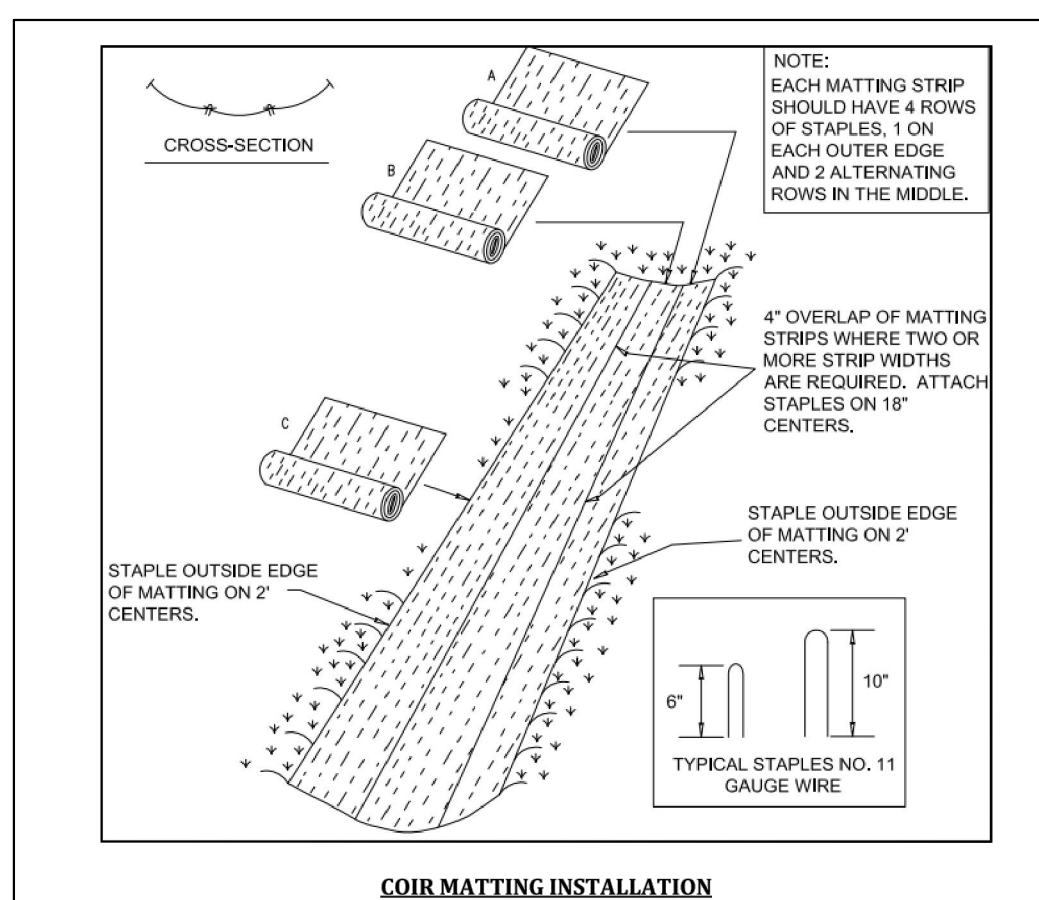

EcoMatting™ is a biodegradable erosion control fabric made up of a single layer of continuously woven, open mesh coir (coconut fiber) matting. It is designed to be used on slopes, shorelines and streamlines for erosion & sediment control. It is also designed to hold seed intact during the establishment of vegetative cover. When it biodegrades also adds nutrients to the soil which help seed establish more rapidly. Coir geotextiles are an environmentally friendly product.

To install simply prepare the slope, apply the appropriate seed and then apply EcoMatting™. EcoMatting™ should be installed as the above diagram recommends. Sod staples or biodegradable stakes should be used to secure the matting to the slope. Matting should be left in place to biodegrade and allow the vegetation to establish. See Specification Sheets for technical information on our coir matting.

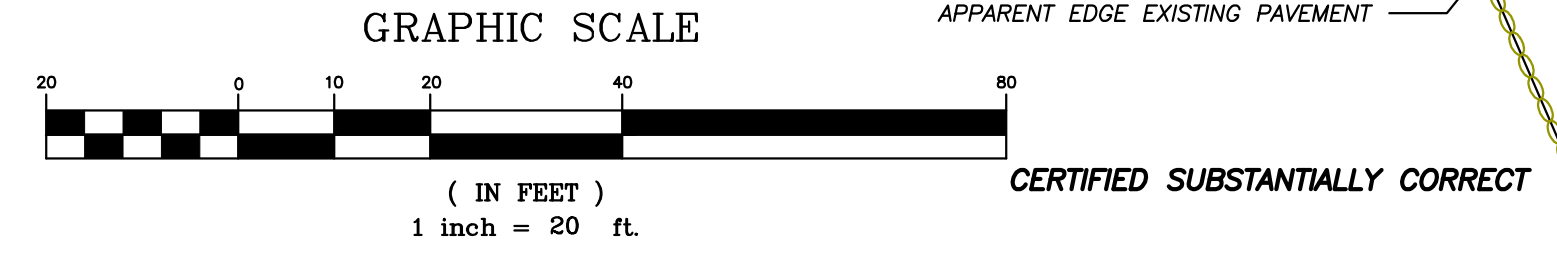
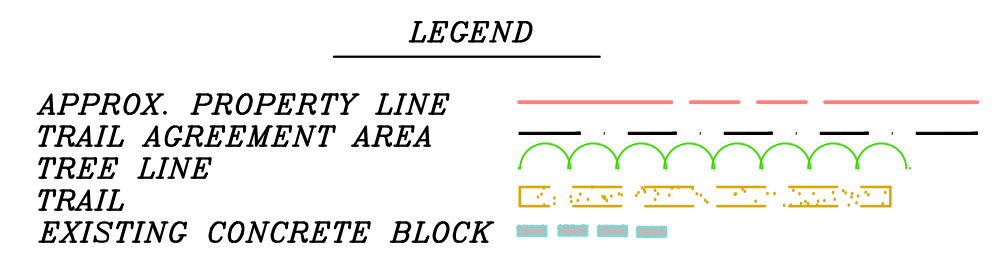

4.	added bike racks, benches, picnic table & extended retaining wall	5/25/20
3.	address staff comments	1/3/20
2.	add erosion control plan narrative and haybale detail	12/5/19
1.	ADDED HOP RIVER AND HEADWALL	9/24/19
No.	Revision/Issue	Date

NEW PEDESTRIAN/BIKE ACCESS LANES ANDOVER WALKS / RIDES ROUTE 6 & LONG HILL ROAD ANDOVER CT

CIVIL ENGINEERING SERVICES, LLC
203 BOSTON HILL ROAD
ANDOVER CT 06232
ph. (860) 742-0364

Project 1712-ANDO_WALKS	
Date 7-12-2019	Sheet 1 OF 3
Scale 1" = 20'	

CERTIFIED SUBSTANTIALLY CORRECT
GERALD E. HARDISTY, PEL #15974

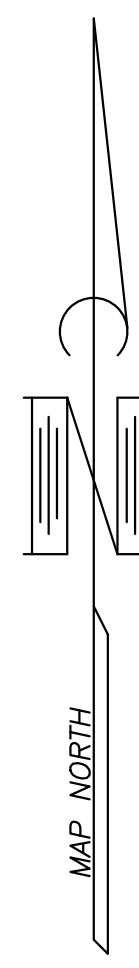
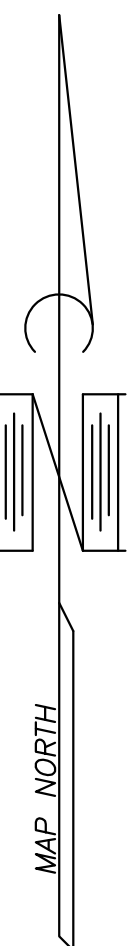
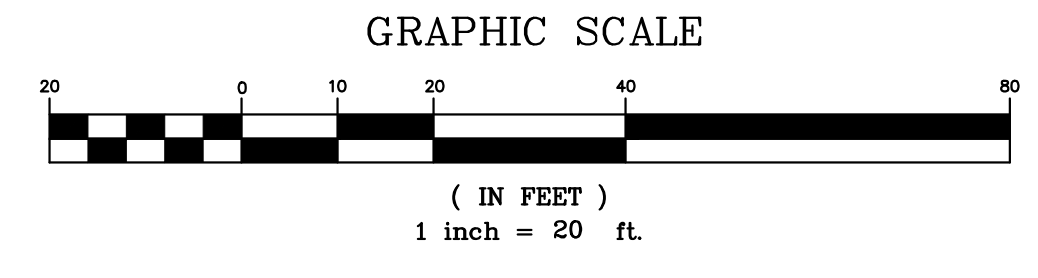
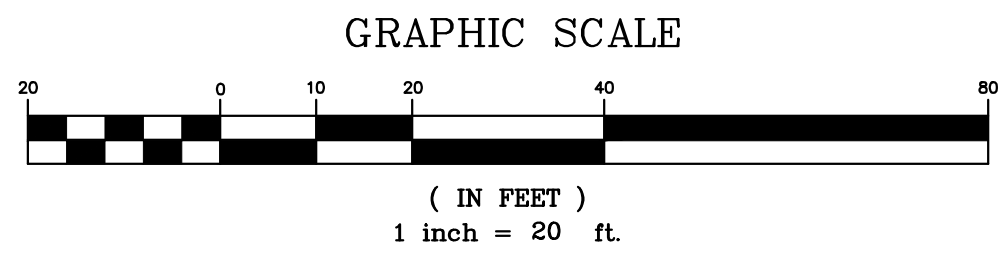
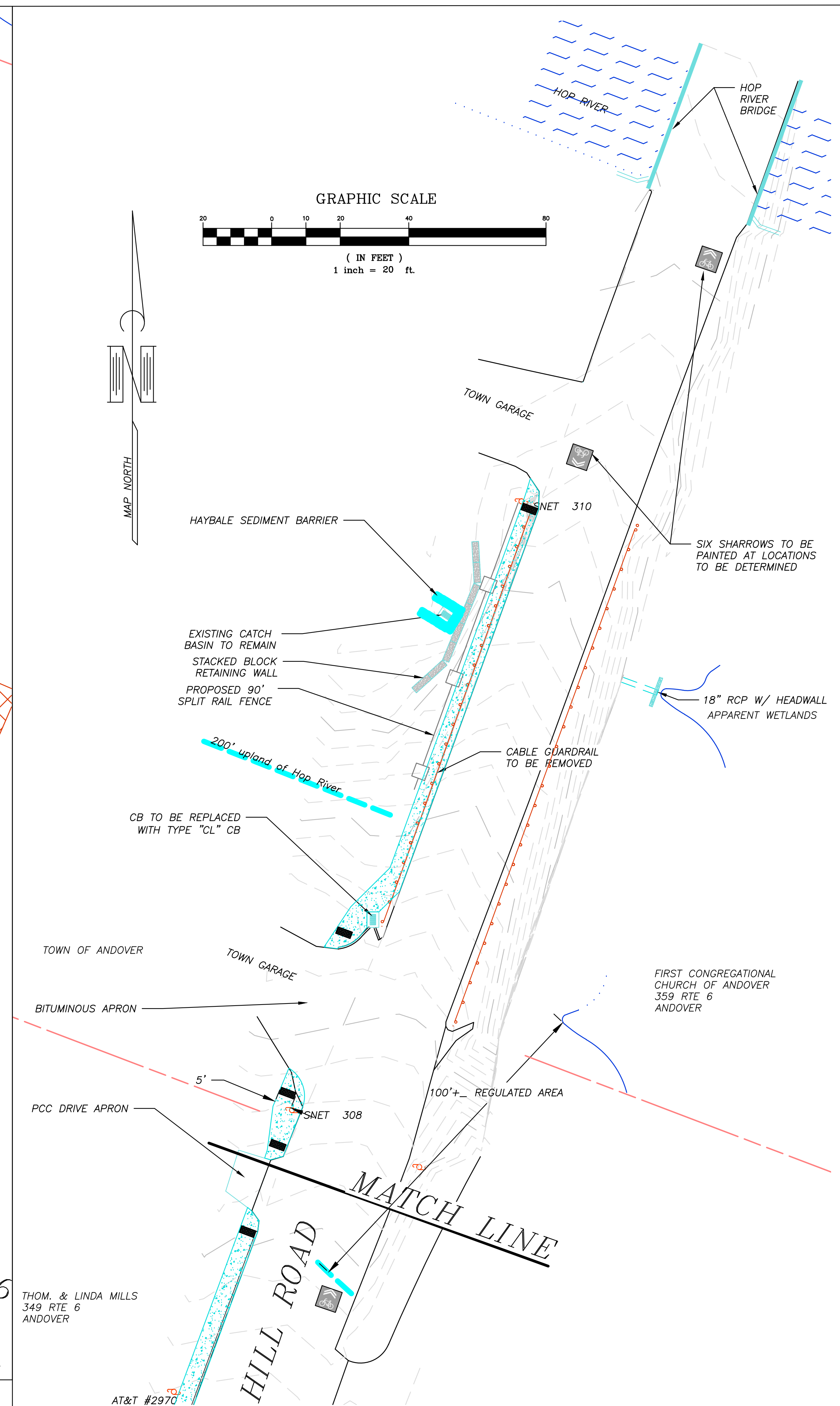
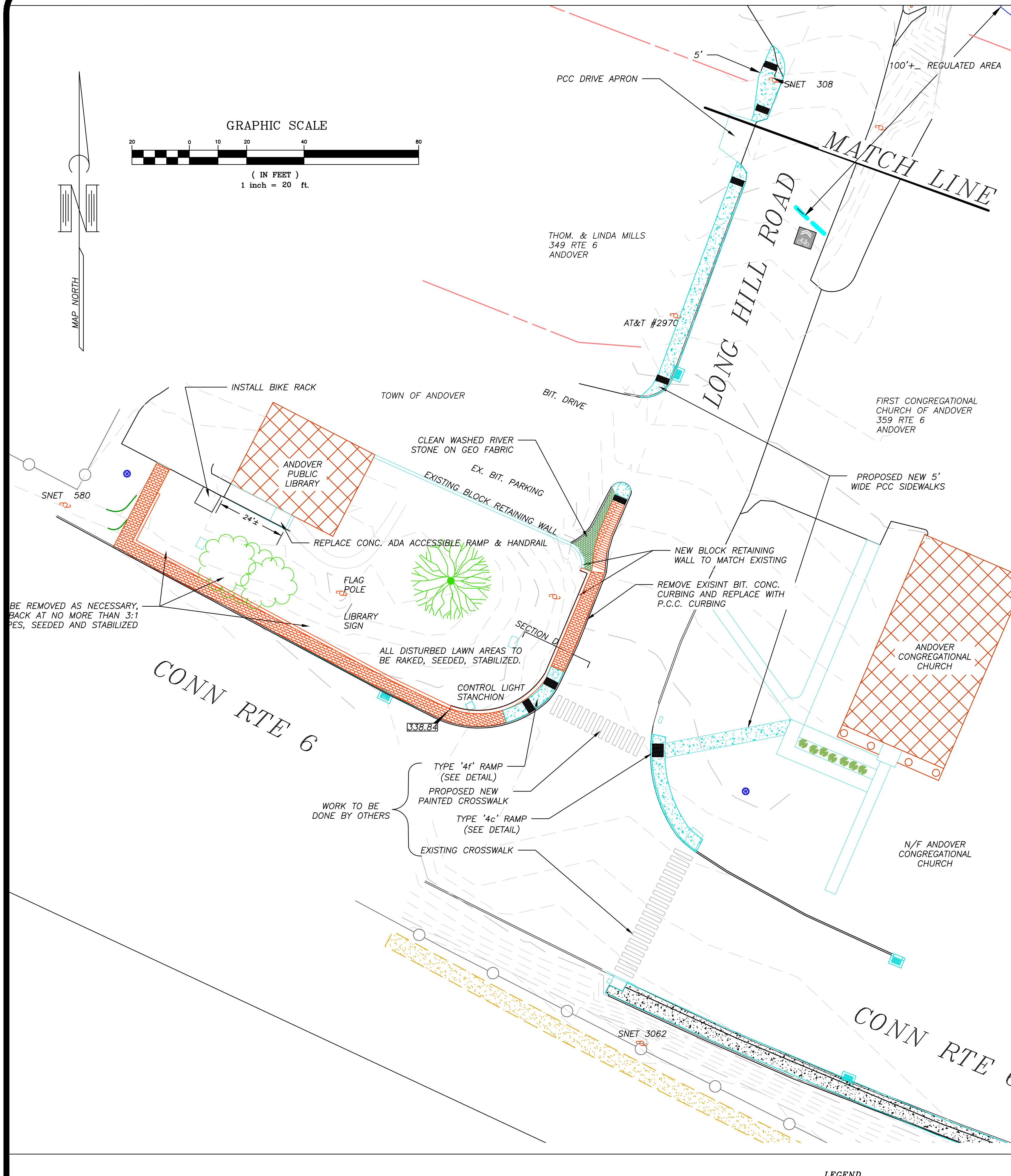

BE REMOVED AS NECESSARY, BACK AT NO MORE THAN 3:1 PES, SEEDED AND STABILIZED

WORK TO BE DONE BY OTHERS

LEGEND

APPROX. PROPERTY LINE	---
TRAIL AGREEMENT AREA	---
TREE LINE	---
TRAIL	---
EXISTING CONCRETE BLOCK	---

No.	Revision/Issue	Date
4.	added bike racks, benches, picnic table & extended ret. wall	5/25/20
3.	address staff comments	1/3/20
2.	add erosion control plan narrative and haybale detail	12/5/19
1.	ADDED HOP RIVER AND HEADWALL	9/24/19

NEW PEDESTRIAN/BIKE ACCESS LANES ANDOVER WALKS / RIDES ROUTE 6 & LONG HILL ROAD ANDOVER CT

CIVIL ENGINEERING SERVICES, LLC
 203 BOSTON HILL ROAD
 ANDOVER CT 06232
 ph. (860) 742-0364

CERTIFIED SUBSTANTIALLY CORRECT

GERALD E. HARDISTY, PEL #15974

Project 1712-ANDO_WALKS	
Date 7-12-2019	Sheet 2 OF 3
Scale 1" = 20'	

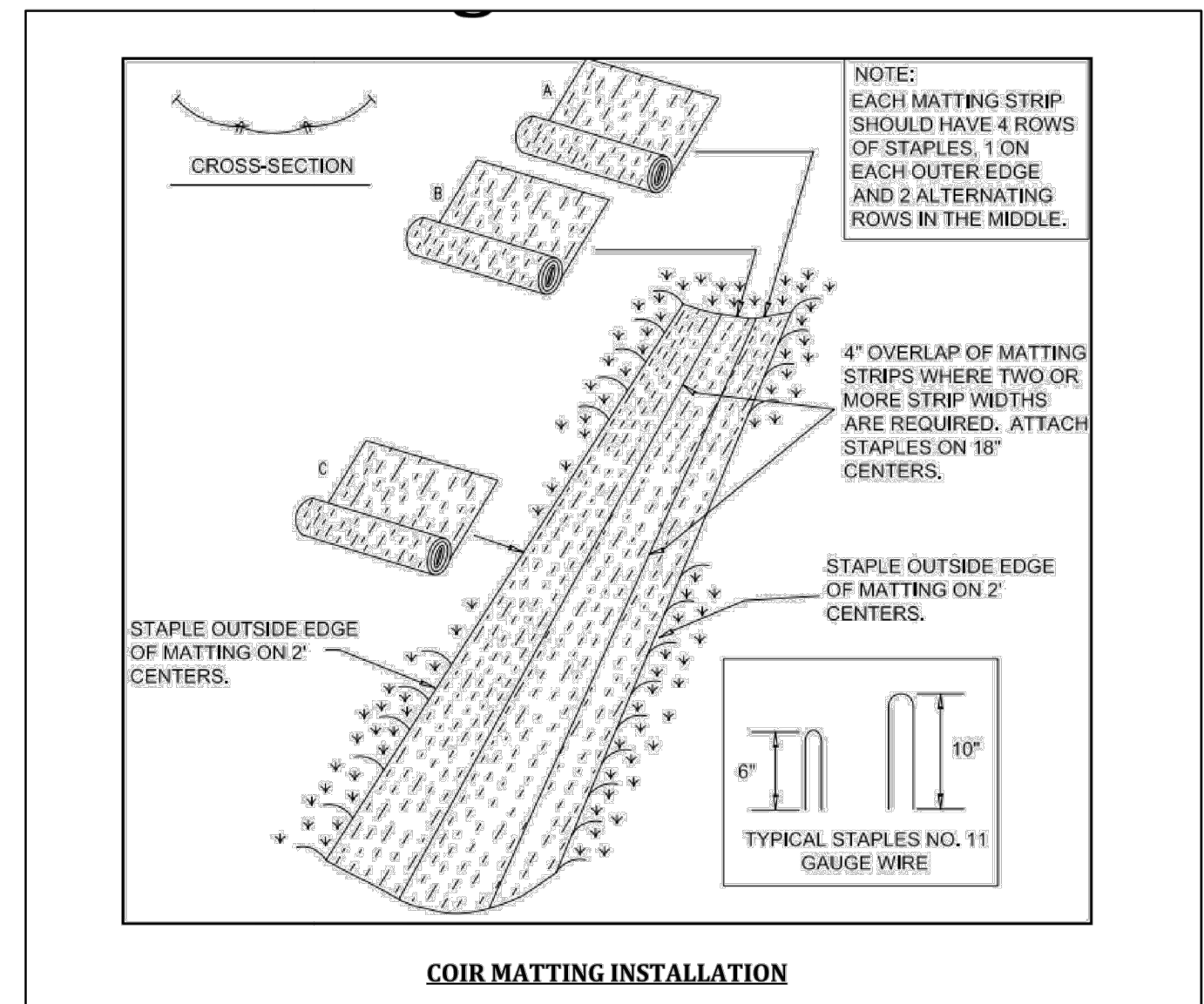
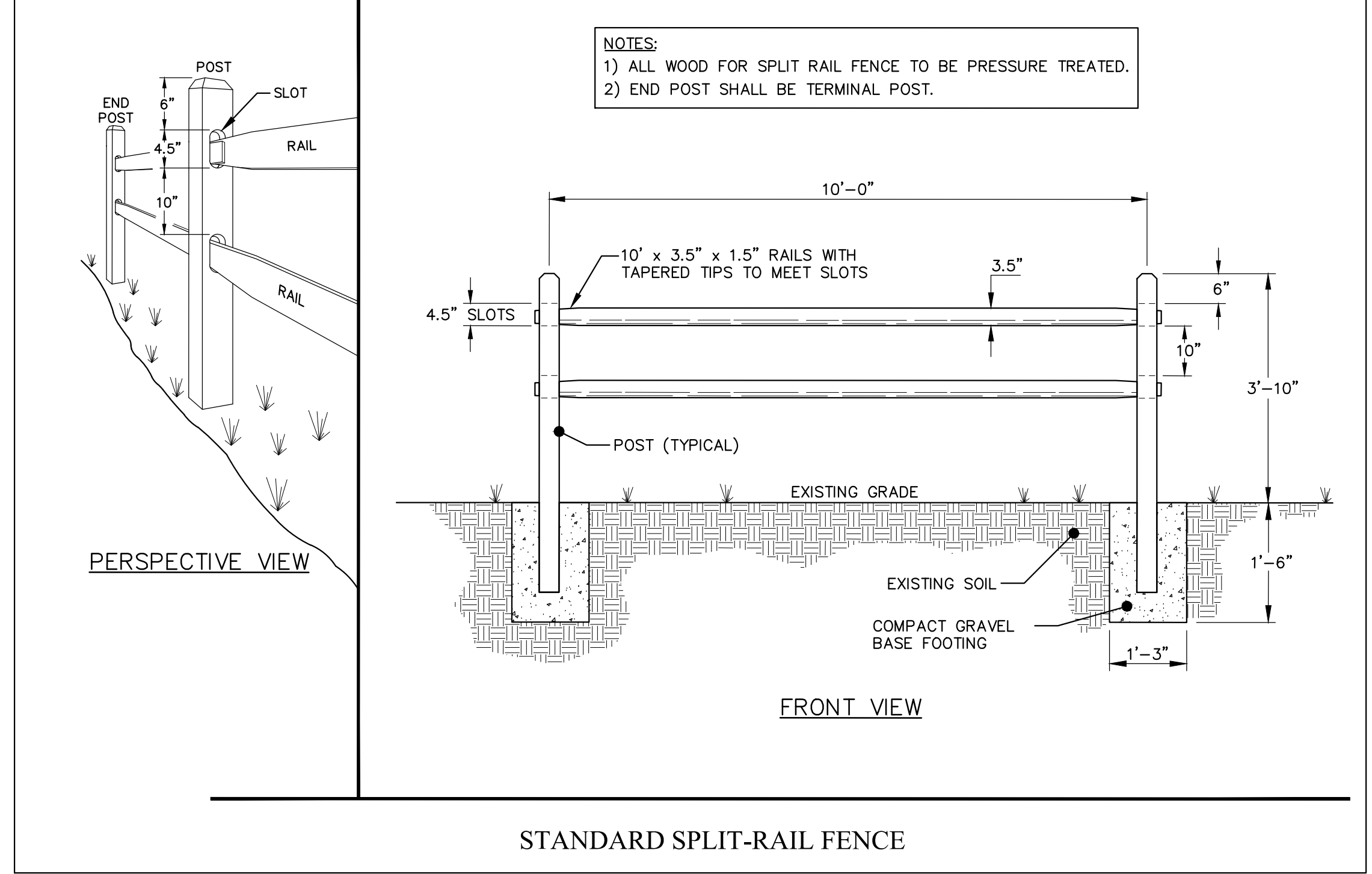
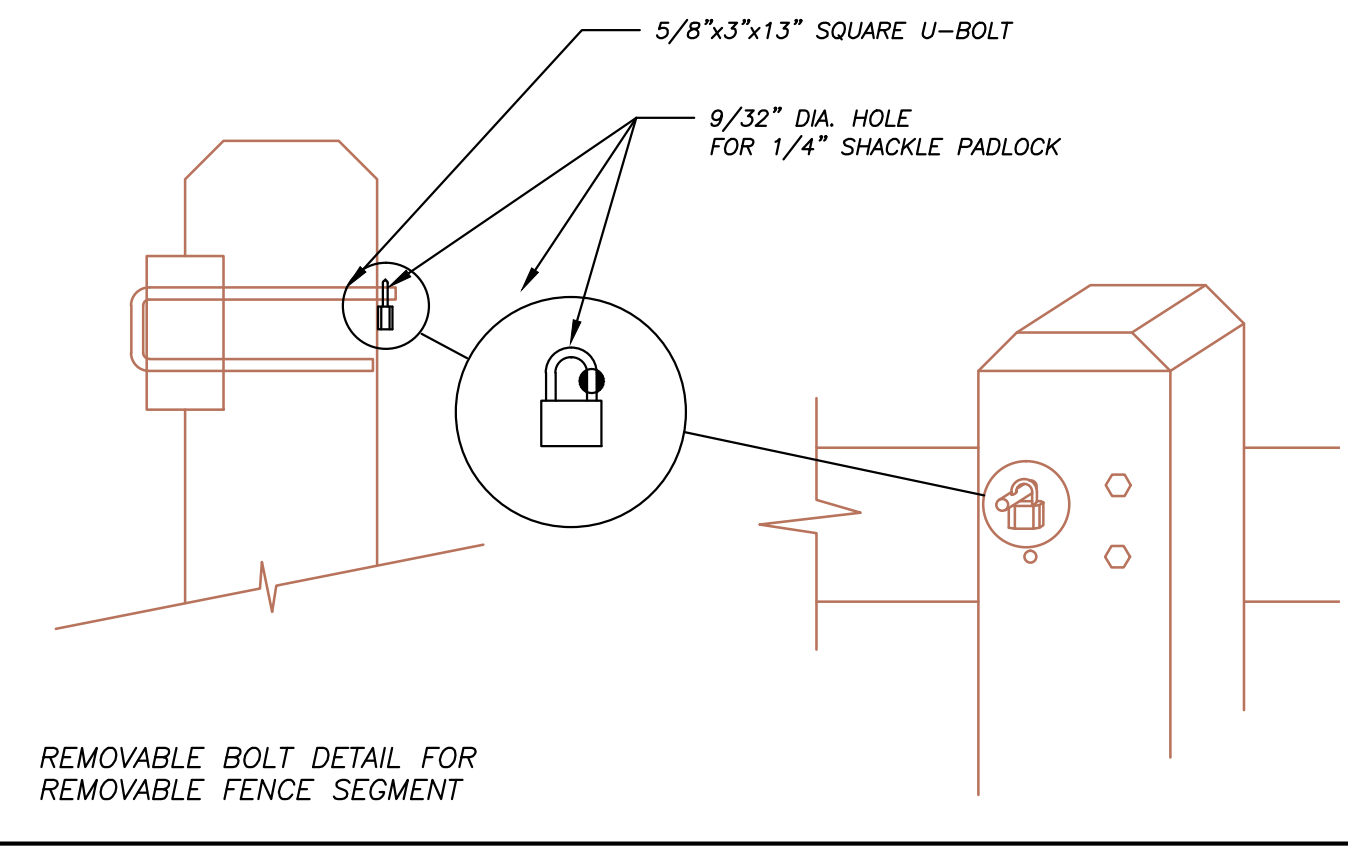
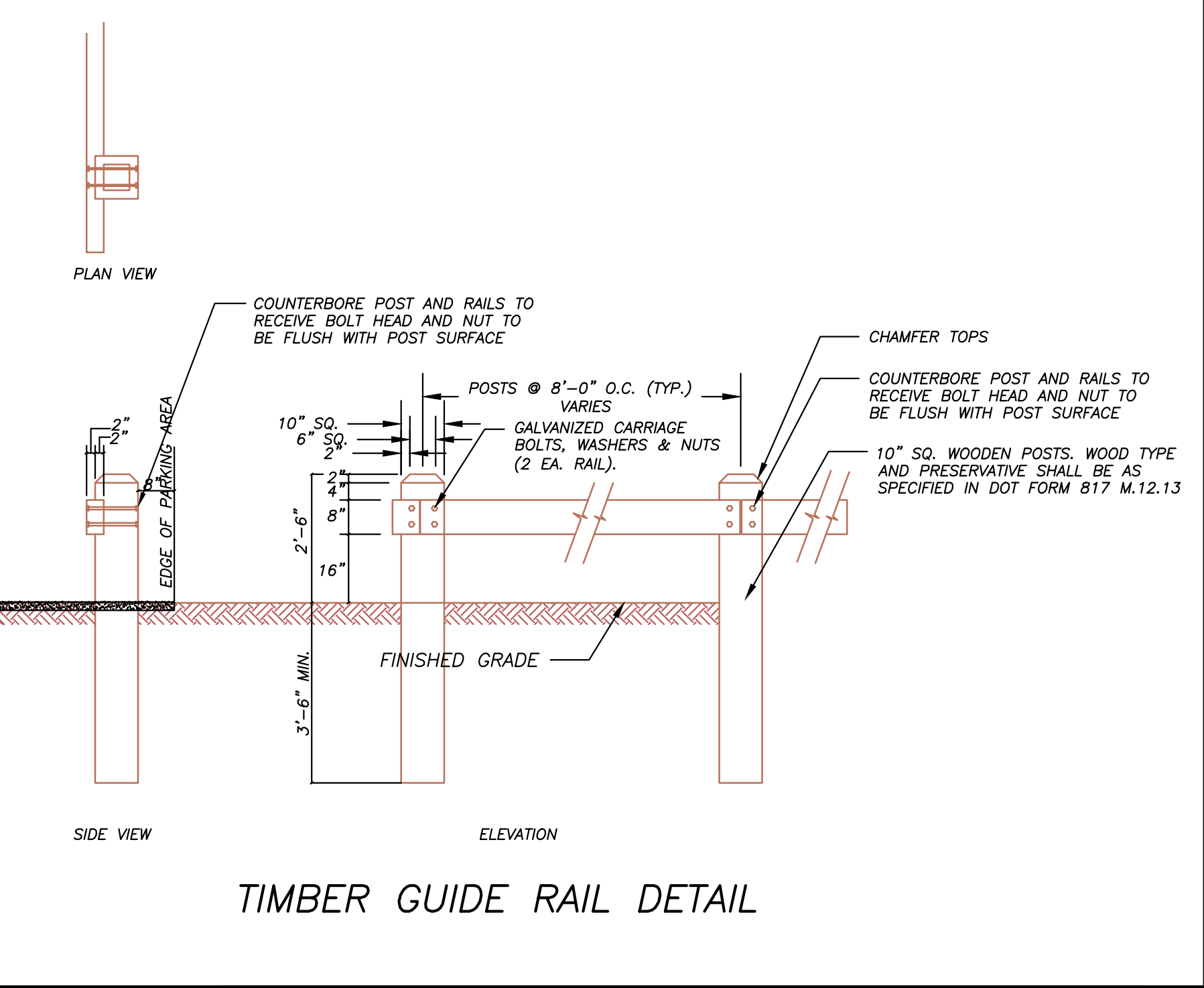
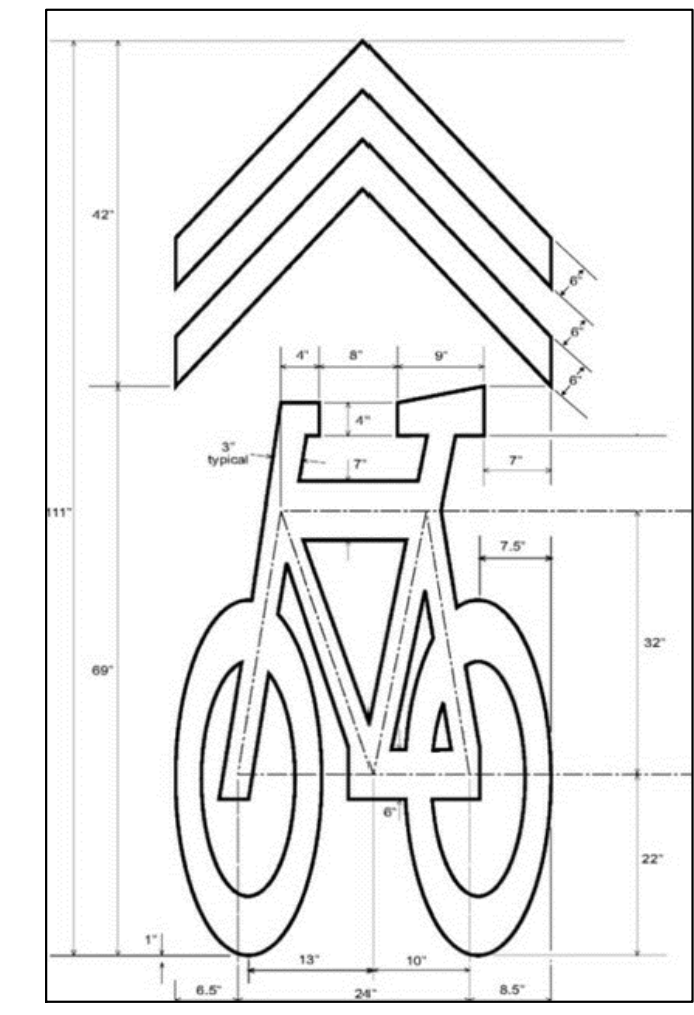
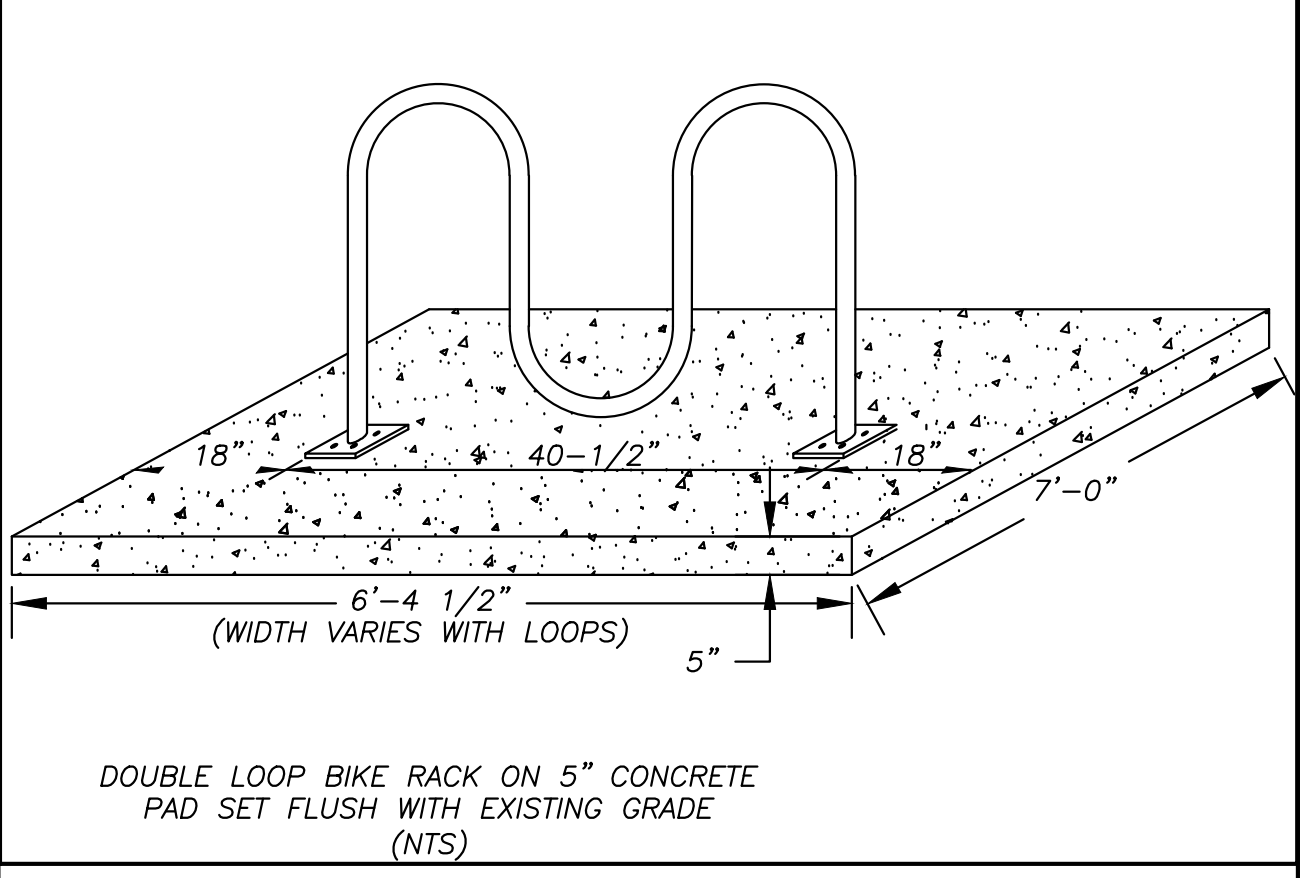
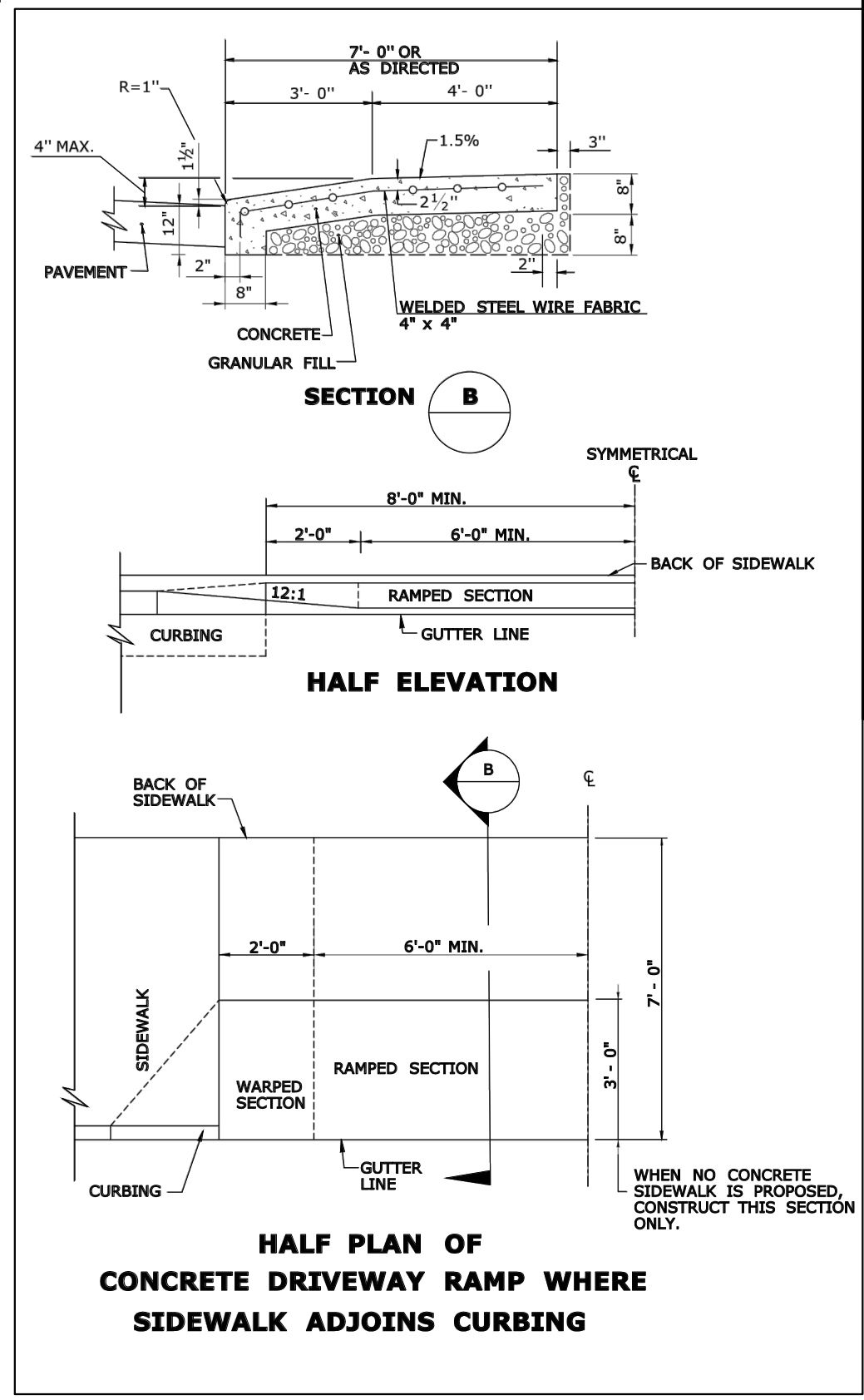
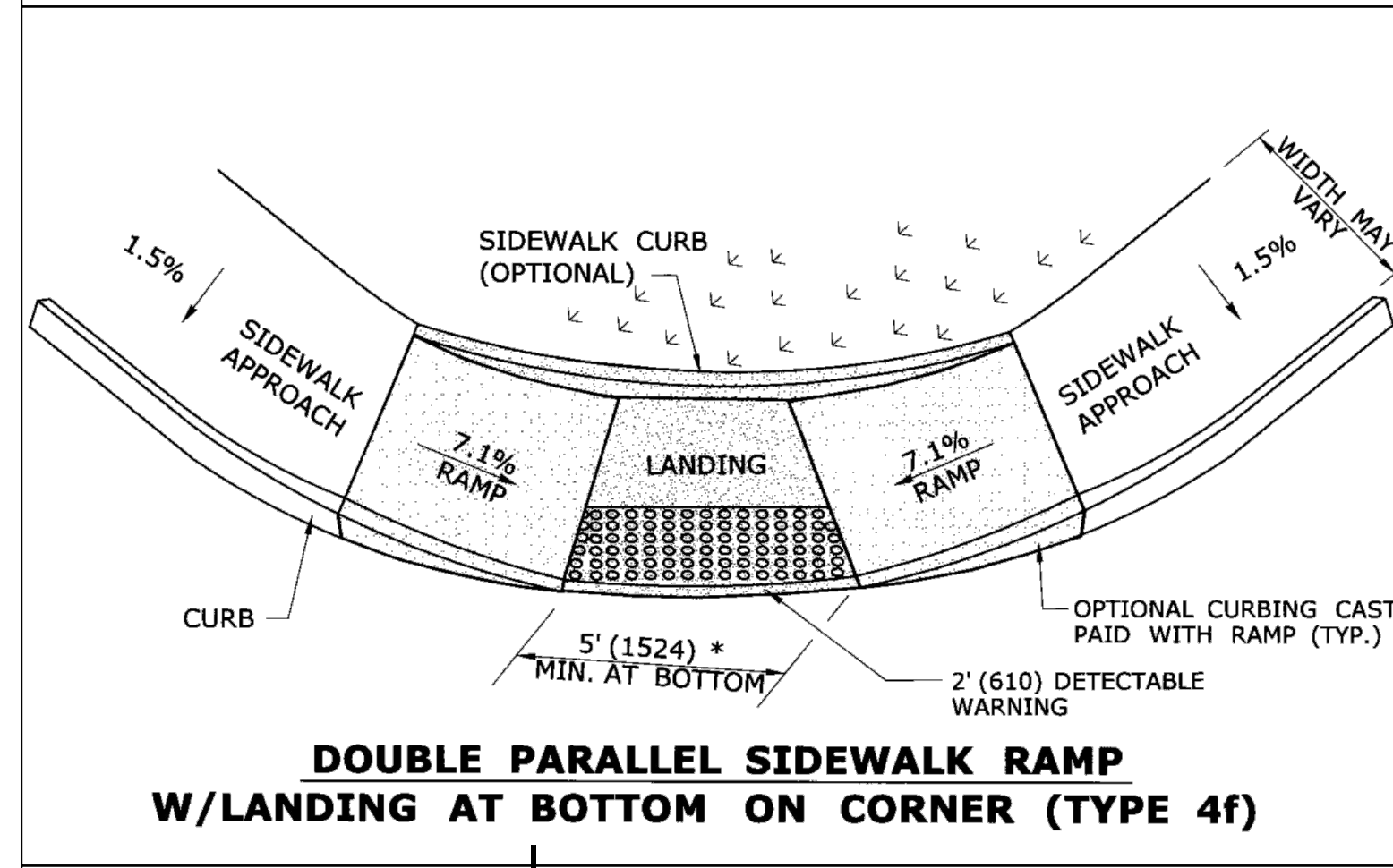
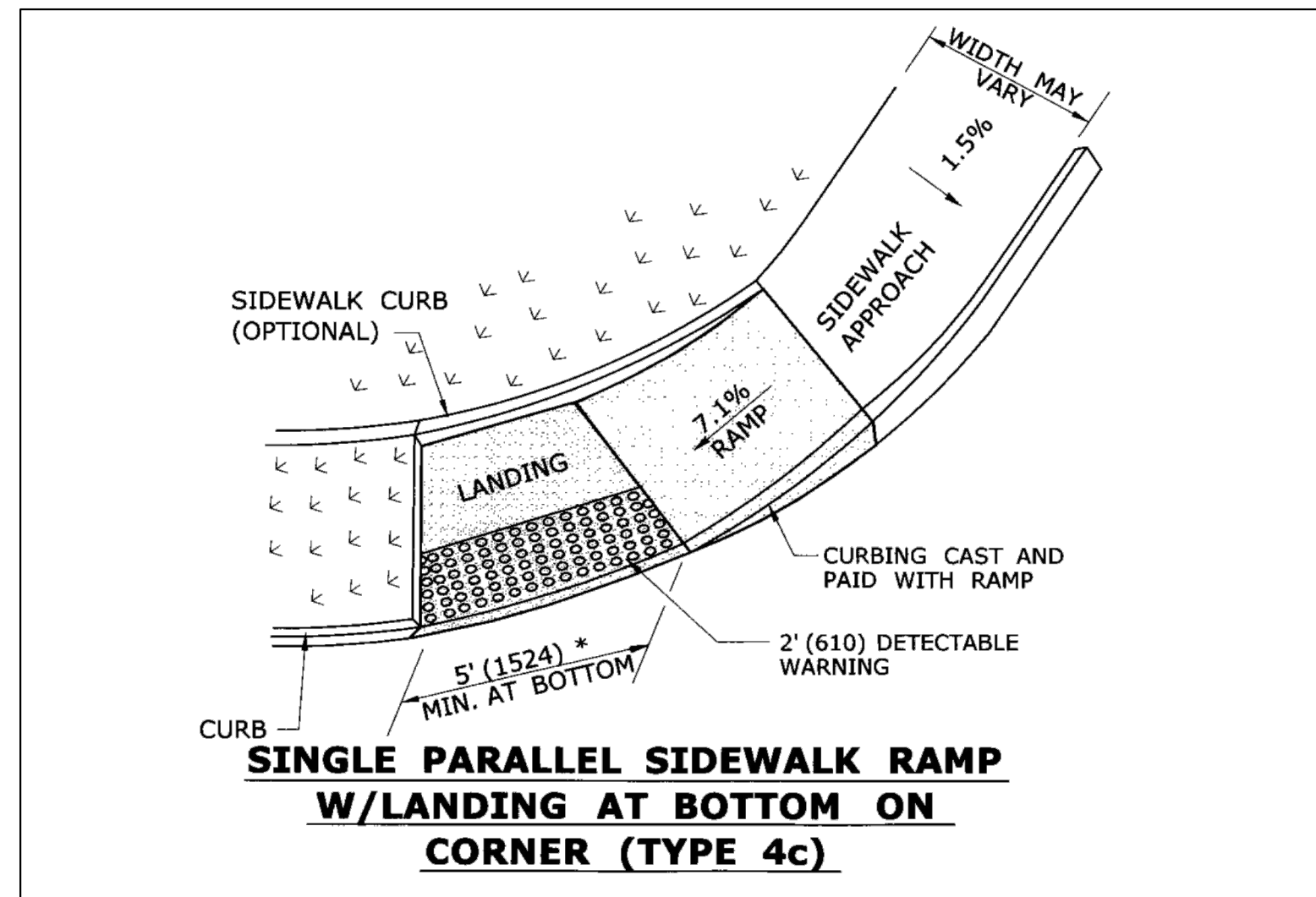

EcoMatting™ is a biodegradable erosion control fabric made up of a single layer of continuously woven, open mesh coir (coconut fiber) matting. It is designed to be used on slopes, shorelines and streamlines for erosion & sediment control. It is also designed to hold seed intact during the establishment of vegetative cover. When it biodegrades also adds nutrients to the soil which help seed establish more rapidly. Coir geotextiles are an environmentally friendly product.

To install simply prepare the slope, apply the appropriate seed and then apply EcoMatting™. EcoMatting™ should be installed as the above diagram recommends. Sod staples or biodegradable stakes should be used to secure the matting to the slope. Matting should be left in place to biodegrade and allow the vegetation to establish. See Specification Sheets for technical information.

BIODEGRADABLE EROSION CONTROL MATTING SHALL BE USED FOR THE LENGTH OF THE SWALE AND SHALL BE MAINTAINED UNTIL THE SWALE HAS BECOME FULLY STABILIZED WITH VEGETATION. THE ILLUSTRATION ABOVE IS FOR GENERAL INFORMATION; OTHER MANUFACTURERS MAY REQUIRE OTHER INSTALLATION PATTERNS. INSTALLATION OF THE MATTING SHALL BE IN ACCORDANCE WITH THE MANUFACTURERS RECOMMENDATIONS.

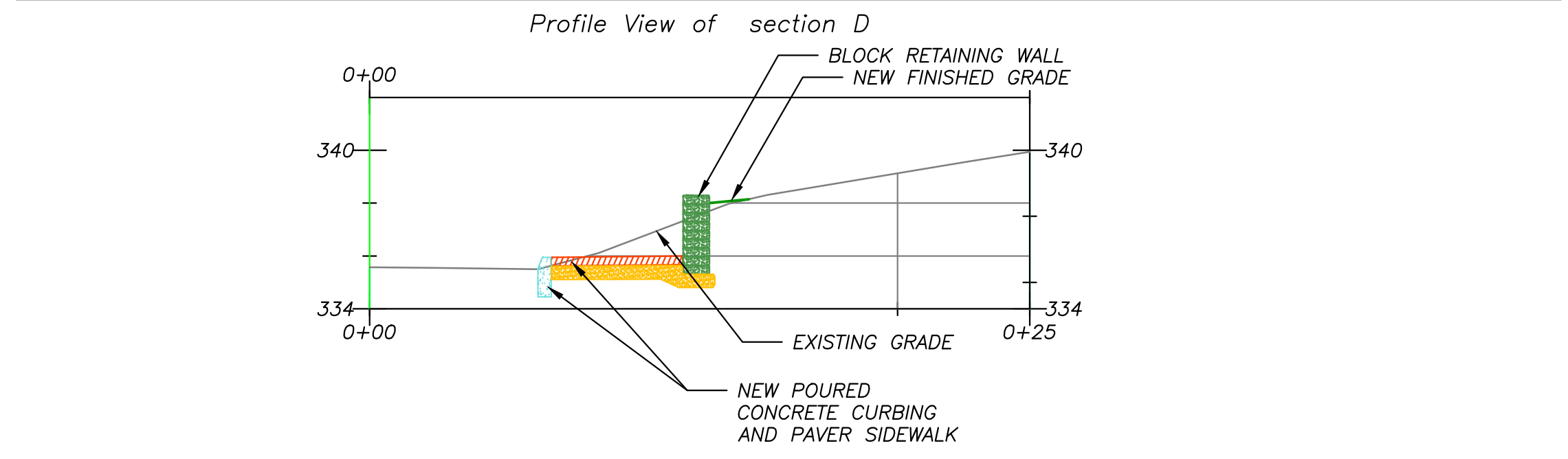
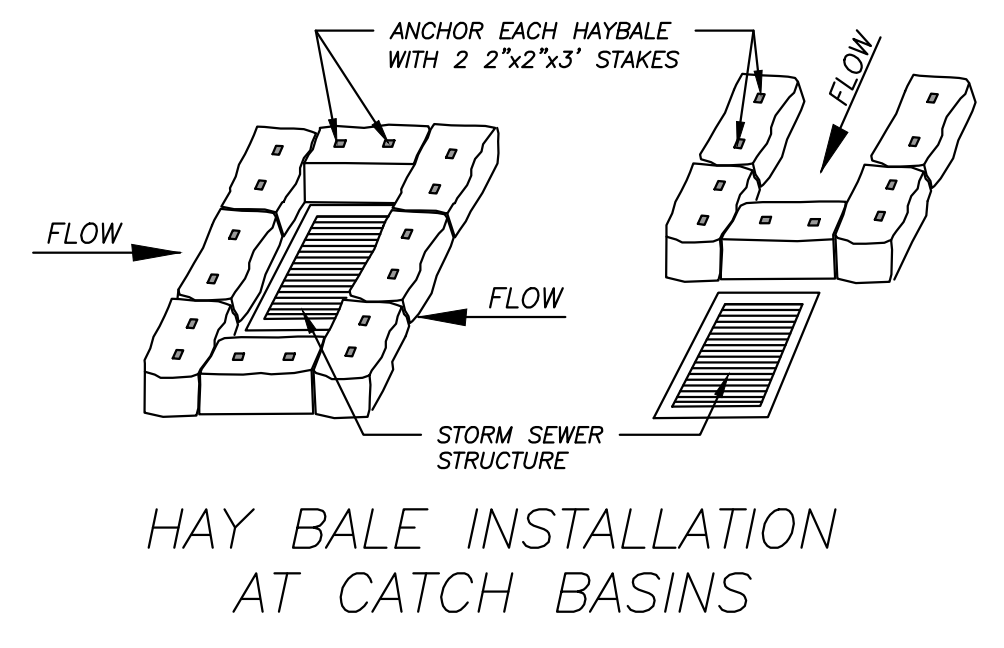

General Notes

ASSESSOR'S MBL: 27-0017-00003
VOL. 1347, PG. 093

NO MAP REFERENCED; DIMENSIONS SHOWN ARE BY DEED; APPARENT BOUNDARY LINES BY LINES OF OCCUPATION.

No.	Revision/Issue	Date
4.	added bike racks, benches, picnic table & extended ret. wall	5/25/20
3.	address staff comments	1/3/20
2.	add erosion control plan narrative and haybale detail	12/5/19
No.	Revision/Issue	Date

**NEW PEDESTRIAN/BIKE
ACCESS LANES
ANDOVER
WALKS / RIDES
ROUTE 6 & LONG HILL
ROAD
ANDOVER CT**

**CIVIL
ENGINEERING
SERVICES, LLC.**
203 BOSTON HILL ROAD
ANDOVER CT 06232
ph. (860) 742-0364

Project	1712-ANDO_WALKS	
Date	7-12-2019	Sheet
Scale	1" = 20'	3 OF 3

CERTIFIED SUBSTANTIALLY CORRECT

GERALD E. HARDISTY, PEL #15974