

8. Project Description

Tear down/Rebuild existing 8'x8' shed and rebuild to fit existing 9'x12' concrete slab. Build pergola over adjacent pre-existing 10'x10' slab. Construct stone patio and raised garden over existing 9'x12' partially buried foundation remnant of a pre-existing outbuilding.

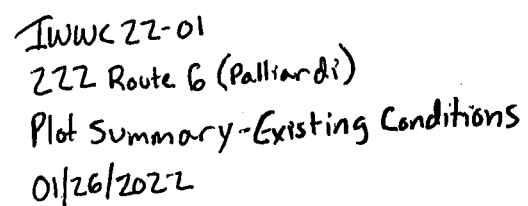

01/26/2022

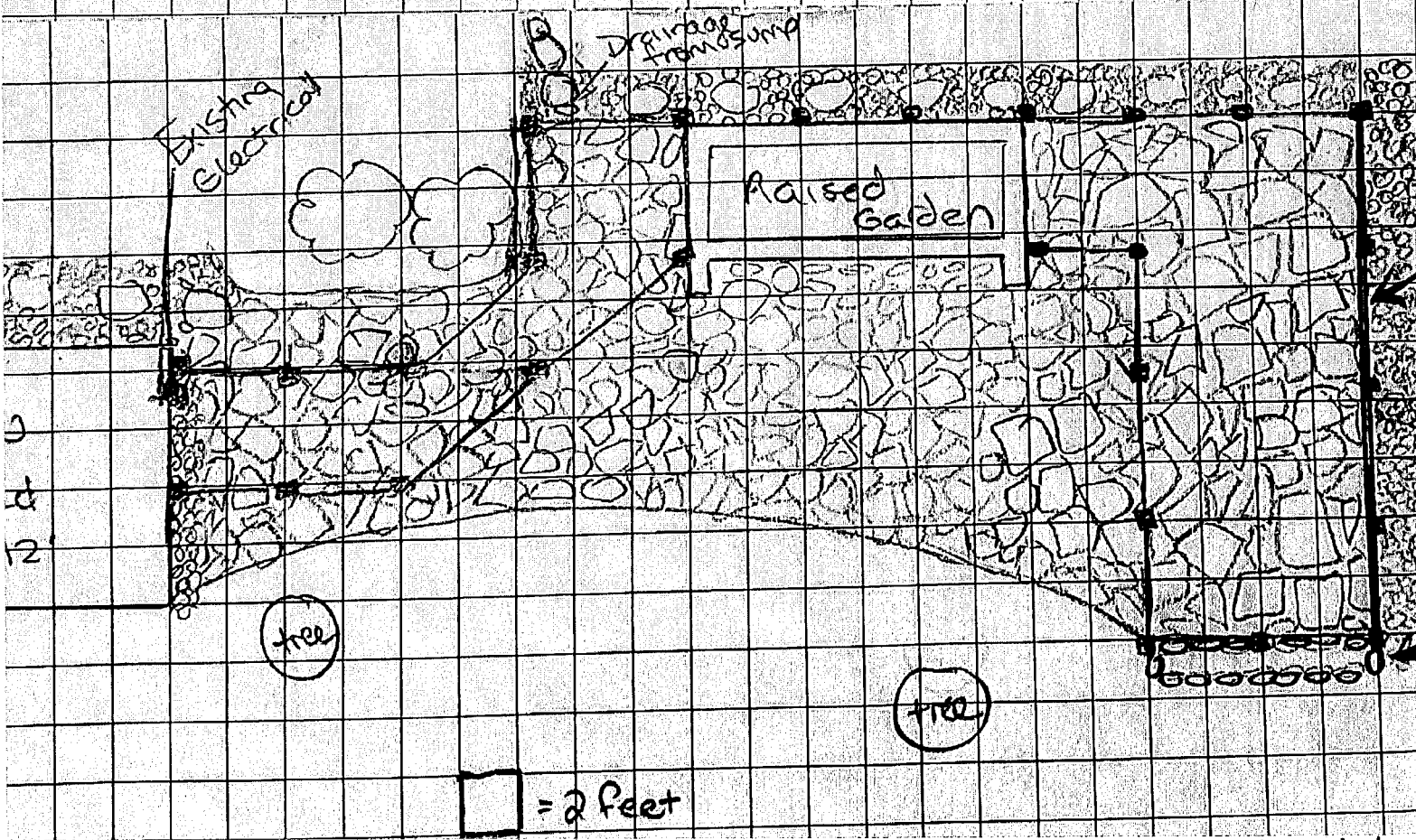
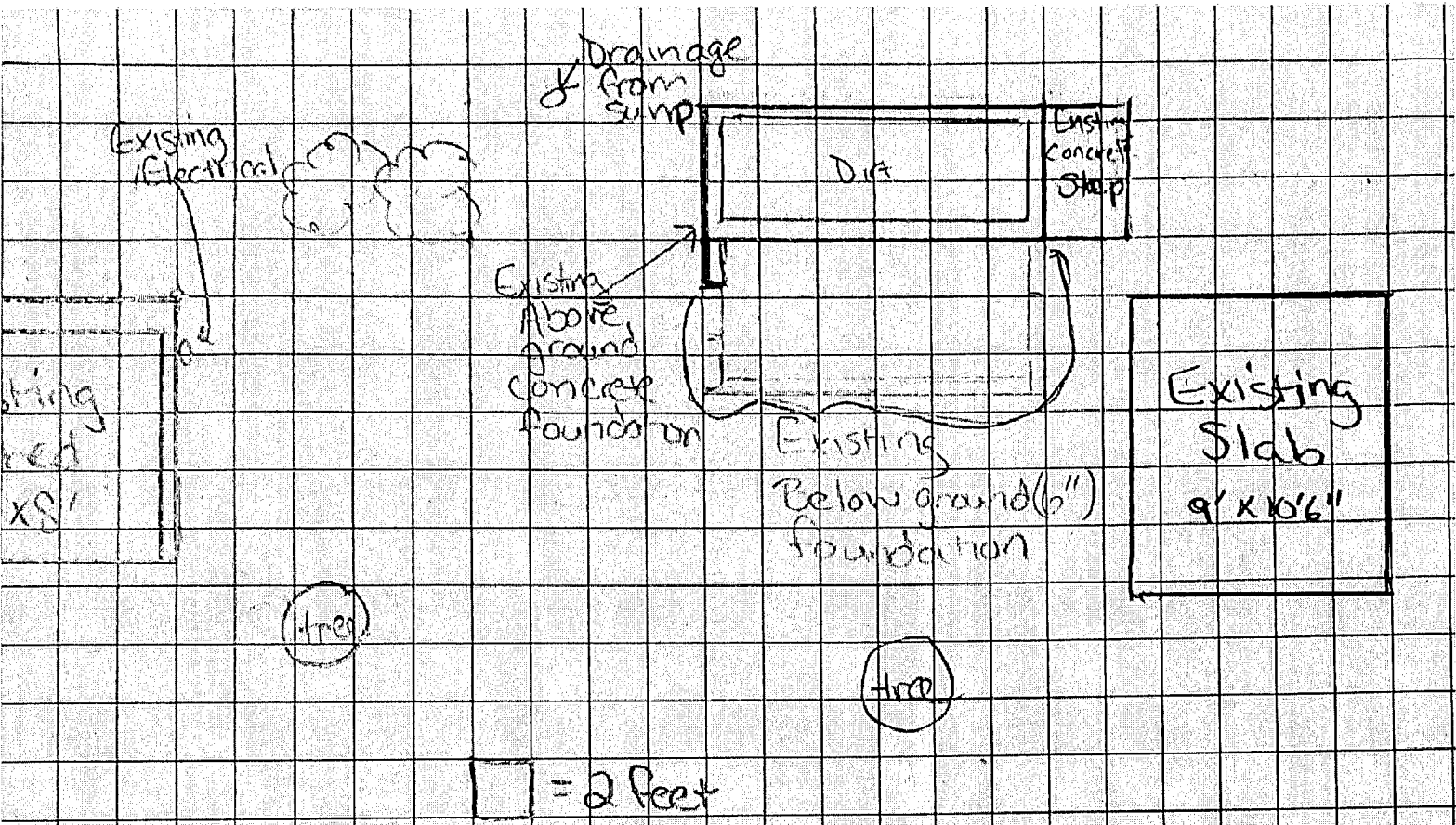

IWWC 22-01
222 Route 6 (Palliardi)
EHHD Approval
01/26/2022



Eastern Highlands Health District

4 South Eagleville Road Phone: (860) 429-3325 Fax: (860) 429-3321 Web: www.EEHD.org

PHR-22-11
Approval

January 26, 2022

Mary Palliardi
222 Route 6
Andover Connecticut 06232

PHR-22-11 Public Health Review - Additions, Renovations, Change of Use, Tear Down/Rebuild Tear down existing 8'x8' shed and rebuild to fit existing 9'x12' slab. Install pergola over second existing 9'x10' slab. Install patio and raised garden over site of existing 9'x12' foundation.

Location: 222 ROUTE 6

Dear Mary Palliardi:

Your application for the above referenced project has been reviewed for compliance with the Connecticut Public Health Code and Technical Standards. The plan is approved with the following conditions:

1. Per the plan submitted 12-25-21.
2. A CCA is available for a 4 BR dwelling.
2. Maintain 10 FT from septic system to the proposed accessory structures.

We will notify the local building official of this health district approval, but you should contact the town directly to determine when all our required permits will be approved for your project. Please note that any revisions to the approved plans, whether proposed by you or required by others, must be reviewed by the health district to verify compliance with the Public Health Code.

If you have any questions, please contact me.

Sincerely,

Thad King, MPH, REHS RS

860-429-3325 (Mansfield)

Preventing Illness & Promoting Wellness for Communities In Eastern Connecticut
860-649-8066 x6108 (Bolton)
Andover * Ashford * Bolton * Chaplin * Columbia * Coventry * Mansfield * Scotland * Tolland * Willington