

\$ PAID

- Revised 12/9/2021 (SW)

RECEIVED

Date Submitted NOV 22 2021

Fee Paid 210.00

Application # SWWC 21-26

TOWN OF ANDOVER
INLAND WETLANDS & WATERCOURSES COMMISSION
Application for Permit

****You MUST submit application to the Building Department by the close of the workday (3:00pm) THURSDAY of the week before the next regularly scheduled meeting of the IWC. If Thursday is a holiday, submit the Wednesday before.**

1. TODD PERKINS CELL
Name of Applicant Evening Phone #
1 LAKESIDE DRIVE CELL
Mailing address Daytime Phone #
ANDOVER, CT., 06232 (203) 494-2520
Town/State/Zip Cellular Phone #

2. Home Improvement Contractor 860.871.7203
Name of Authorized Agent Daytime Phone #
(if different from applicant, example: architect/engineer/surveyor/attorney)
Deane Maselek 860.416.2399
Business Name Cellular Phone #
7 NUTMEG DR. #B16 ELLINGTON, CT 06029
Address Town/State/Zip

3. Applicants interest in the Property (please circle):
Owner Developer Builder Option holder Other

If Applicant is NOT the owner, please provide:

N/A
Name and Address of Owner

Home Phone Business Phone Cellular Phone #

4. Has an application been filed with the Planning & Zoning Commission? NO
Is this land part of a previously Approved Subdivision? _____
If so, attach copies of all permits.

5. Identify any other State or Town Permits pending for work on this property or required for work on this property. N/A

6. Location of Property where proposed activity is to take place:

1 LAKESIDE DRIVE, ANDOVER, CT Map 43 Block 47 Lot 77
Street address Tax Assessor's Reference

Nearest telephone pole # _____

Subdivision & Lot # _____

Distance to intersection _____

7. **Map/Site Plan** (all applications) (**10 copies** of application and plans are required)

- 1) Attach to the application a map or site plan showing **existing conditions** and the **proposed project** in relation to wetland/watercourses. Scale of map or site plan should be 1" = 20', 1" = 30, or 1" = 40'; if this is not possible, please indicate the scale that you are using. A sketch map may be sufficient for small, minor projects. (See guidelines at end of application)
- 2) Applicants map date and date of last revision 11.21.2021
- 3) Zone Classification _____
- 4) Is your property in a flood zone? _____ yes ☒ no _____ don't know

(Use a separate 8 1/2 x 11 sheet if necessary)

8. **Project description** (attach extra pages if necessary)

- Describe in detail the proposed activity here or on an attached page. (see guidelines at end of application)
- Please include a description of all activity or construction or disturbance:
- Type and volume of material to be filled or excavated:
 - a) in the wetland/watercourse
 - b) in the area **adjacent** to (within 100 feet from the edge of) the wetland/watercourse, even if the wetland/watercourse is **off** your property.

~~a)~~ - Stone wall on my FRONTAGE IS IN NEED OF REPAIR. STONES NEED TO BE PUT BACK IN PLACE. MORTAR NEEDS TO BE REPLACED.

b) - Several holes and areas of previous erosion on the northwest side of the wall will be filled with topsoil and seeded. Area will be restored and level with existing lawn.

NOV 22 2021

- Describe the amount and area of disturbance (in percentage of acre or cubic yards of material to be deposited)
 - a) in the wetland/watercourse
 - b) in the area **adjacent** to (within 100 feet from the edge of) the wetland/watercourse, even if the wetland/watercourse is off your property.

a) ~~APPX. 120 FEET OF STONE WALL, PRE-EXISTING~~
STONE TO BE PLACED BACK, AND FORMER MORTAR
REPLACED.

b) - Approximately 4-5 cubic yards of topsoil to be placed on lawn side of Lake wall.

9. **Proposed erosion and sedimentation controls and other management practices and mitigation measures** which may be considered as a condition of issuing a permit for the proposed regulated activity including, but not limited to, measures to (1) prevent or minimize pollution or other environmental damage, (2) maintain or enhance existing environmental quality, or (3) in the following order of priority; restore, enhance and create productive wetland or watercourse resources; alternatives considered and subsequently rejected by the applicant and why the alternative as set forth in the application was chosen; all such alternatives shall be diagramed on a site plan or drawing.

10. **Names and Addresses of adjacent property owners:**

RUSSELL DEPATIE 196 LAKE RD.
IRENE REZMAN 3 LAKESIDE DR.

11. **Owner's consenting signature:**

The undersigned, as owner of the property, hereby consents to the applicant seeking a permit for the proposed activity. The owner also consents to the necessary and proper inspections of the above referenced property, by the Andover Inland Wetlands Commission and its Agent, both before and after a final decision has been made by the Commission.

Signature of Owner

Date

12. **Signature of Applicant:**

The undersigned is familiar with all the information provided in this application and is aware that any permit obtained through deception, inaccurate or misleading information is subject to revocation.

Signature of Applicant

Date

13. Additional information – if deemed a significant activity by the commission additional information is required – see section 7.6 of the commission's regulations.
14. Filing fee – Consult regulations and Wetlands Agent for appropriate fees.

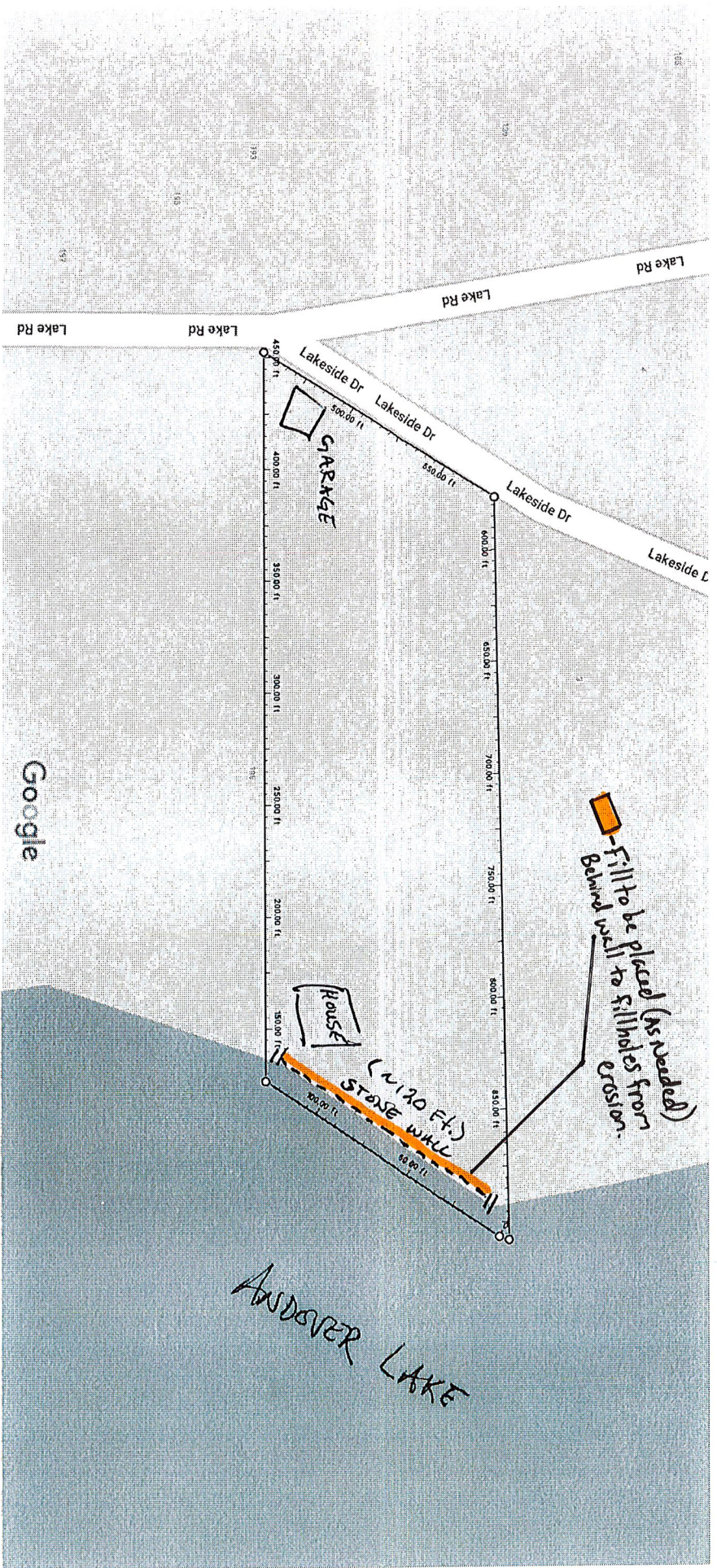

Application IWWC 21-26
1 Lakeside Drive (Perkins)

Measure distance
Total area: 34,546.63 ft² (3,209.49 m²)
Total distance: 907.91 ft (276.73 m)

RECEIVED
NOV 22 2021

— Revised 12/09/2021
(Placement of fill behind stone wall)

Map data ©2021

11/21/2021